

REPLACEMENT PARTS GUIDE

6080A E Cut Lightweight Fairway Mower

ENGINE



OIL FILTER
[M806418](#)

Change every 250 hrs.



ENGINE OIL
[TY26669](#) (Plus-50™ II 10W-30)
(WITH FILTER - 3.4 L (3.6 qt))
(WITHOUT FILTER - 3.2 L (3.4 qt))

Change every 250 hrs.



FILTER ELEMENT
[M131802](#) (PRIMARY)



[M131803](#) (SECONDARY)

Change every 500 hrs / Yearly.



JOHN DEERE MULTI - PURPOSE SD POLYUREA GREASE
[TY6341](#) (FOR MACHINE AND LIFT ARMS)
JOHN DEERE SPECIAL PURPOSE GOLF AND TURF CUTTING UNIT GREASE
[TY25083](#) (FOR CUTTING UNIT AND CUTTING UNIT ATTACHMENTS)

GREASE GUN
[TY26183](#)

Change As Required.



FUEL FILTER
[MIU800645](#)

Change every 500 hrs / Yearly.



V - BELT
[TCU38089](#) (LGTH = 1475 mm, TK = 12 mm, WIDTH = 11 mm) (FAN)



FUEL FILTER ELEMNT
[M811032](#)

Change every 500 hrs.



HYDRAULIC FILTER ELEMENT
[UC34161](#) (S/N (- 050000))
[UC33371](#) (S/N (050001 -))

change Every 750 Hours / Yearly.

ELECTRICAL



KEY
[AUC12681](#)



IGNITION SWITCH
[AUC18708](#)



BATTERY
[TY25876B](#) (12 V) (FOR CANADA AND USA)
[MCYP25876](#) (12 V) (NOT FOR CANADA AND USA)



THERMOSTAT
[M811895](#)



HEAD LIGHT
[RE573609](#)



WATER TEMPERATURE SWITCH
[CH15516](#)



V - BELT
[UC22770](#) (LGTH = 1438 mm, TK = 5.2 mm, WIDTH = 28.45 mm) (ALTERNATOR)

FUEL & AIR



FILLER CAP
[LVA18519](#)



MUFFLER
[MIU803783](#)



REPLACEMENT PARTS GUIDE

6080A E Cut Lightweight Fairway Mower Reel Cutting Unit



TORSION SPRING

[TCU39484](#) (RH, LATCH)
[TCU39483](#) (LH, LATCH)

STATIONARY KNIFE



[UC28157](#) (HEIGHT OF CUT = 4.8 mm),
 (7 BLADE)
[UC18877](#) (HEIGHT OF CUT = 2.5 mm),
 (7 BLADE)
[UC23445](#) (HEIGHT OF CUT = 7.6 mm),
 (11 BLADE)
[UC18877](#) (HEIGHT OF CUT = 2.5 mm),
 (11 BLADE)
[UC28164](#) (HEIGHT OF CUT = 2.0 mm),
 (LOW CUT), (11 BLADE)
[TCU36878](#) (HEIGHT OF CUT = 2.0 mm),
 (LOW CUT HARDENED
 STEEL), (11 BLADE)

MOWER REEL



[TCA19348](#) (7 BLADE)
[TCA19349](#) (11 BLADE)



ELECTRIC MOTOR
[AUC12499](#)



SYNCHRONOUS BELT
[TCU32422](#) (LGTH = 375 mm,WIDTH = 11 mm)



VOLTAGE REGULATOR
[TCA21972](#)

SCRAPER



[TCA19585](#) (GROOVED FRONT ROLLER
 SCRAPER), (2 INCH)
[BM23014](#) (GROOVED FRONT ROLLER
 SCRAPER), (3 INCH)
[BM23015](#) SMOOTH ROLLER SCRAPER),
 (18 INCH)



GRASS CATCHER
[BTC10716](#) (LOW PROFILE GRASS
 CATCHER), (18 INCH)
[BTC10717](#) (HIGH PROFILE GRASS
 CATCHER), (18 INCH)



REEL CUTTING UNIT
[BUC11254](#) (18 INCH), (7 - BLADE)
[BUC10412](#) (18 INCH), (11 - BLADE)

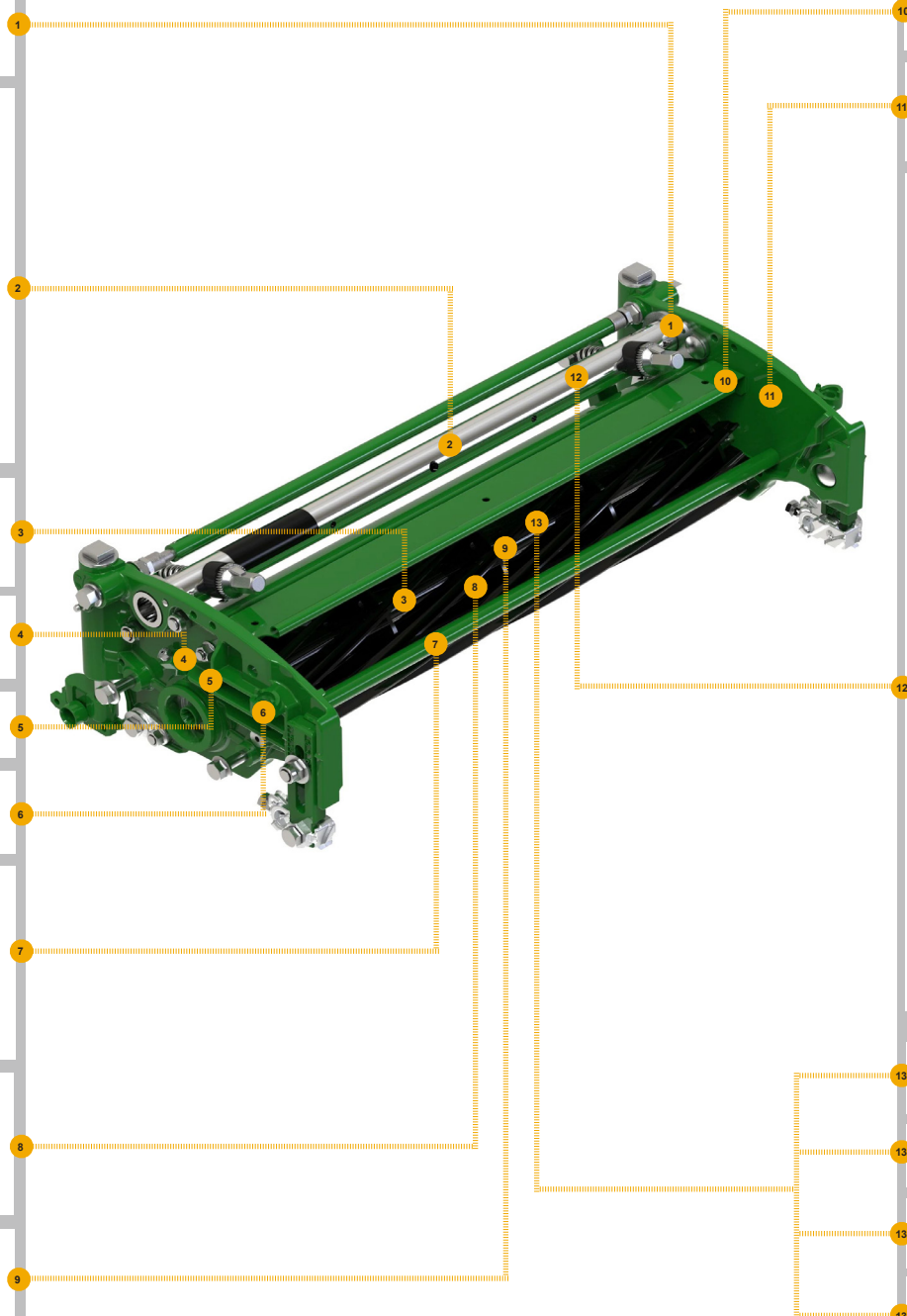

HYDRAULIC MOTOR
[AUC18555](#)



BRACKET
[UC16109](#) (RH)
[UC18211](#) (LH)

ROLLER



[BM22879](#) (MACHINED SPIRAL GROOVE
 FRONT ROLLER KIT), (2 INCH)
[BM22868](#) (MACHINED GROOVED FRONT
 ROLLER KIT), (2 INCH)
[TCU27112](#) (GROOVED FRONT ROLLER
 SCRAPER KIT), (3 INCH)
[BM23567](#) (SPIRAL ROLLER KIT), (2 INCH)
[BM25316](#) (GROOVED DISK ROLLER KIT),
 (3 INCH)
[ET15726](#) (GROOVED DISK ROLLER KIT),
 (3 INCH)
[TCU26890](#) (GROOVED DISK ROLLER KIT),
 (3 INCH)
[TCA19509](#) (SMOOTH ROLLER KIT), (3 INCH)
[ET15726](#) (SMOOTH ROLLER KIT), (3 INCH)
[TCU26890](#) (SMOOTH ROLLER KIT), (3 INCH)
[BM24203](#) (GREENS ROLLER KIT), (2 INCH)
[BM24204](#) (HOLLOW SMOOTH ROLLER KIT),
 (2 INCH)
[AMT2981](#) (SMOOTH FRONT ROLLER KIT),
 (2 INCH)
[AMT2979](#) (GROOVED FRONT ROLLER KIT
 W/FLATS), (18 INCH)
[BTC10281](#) (RELIEVED SHORT GROOVED
 ROLLER KIT), (2 INCH)
[BM20561](#) (MACHINED SMOOTH FRONT
 ROLLER KIT), (2-3/8 INCH)
[BUC10787](#) (SMOOTH ROLLER,
 W/ BEARING), (18 INCH)

VERTICAL CUTTING UNIT



ADJUSTER
[TCU24328](#)



SHIELD
[TCA18643](#)



SHAFT
[AUC14974](#)



BLADE
[TCU26776](#)



CLICK PART NUMBER TO BUY

*See operator's manual for additional details.