

REPLACEMENT PARTS GUIDE

8900A Large Area Reel Mower

FUEL AND AIR



FILLER CAP
[LVA18519](#)



KEY
[AUC12681](#)



ROTARY SWITCH
[AUC18708](#)



BATTERY
[TY25876B](#) (12V) (FOR CANADA AND USA)
[MCYP25876](#) (12V) (NOT FOR CANADA AND USA)



THERMOSTAT
[M811034](#)



WATER TEMPERATURE SWITCH
[CH15516](#)



TIE ROD ENDS
[TCA23641](#)



JOHN DEERE SPECIAL PURPOSE GOLF AND TURF CUTTING UNIT GREASE
[TY25083](#)

JOHN DEERE MULTI-PURPOSE SD POLYUREA GREASE
[TY6341](#) Change As Required.

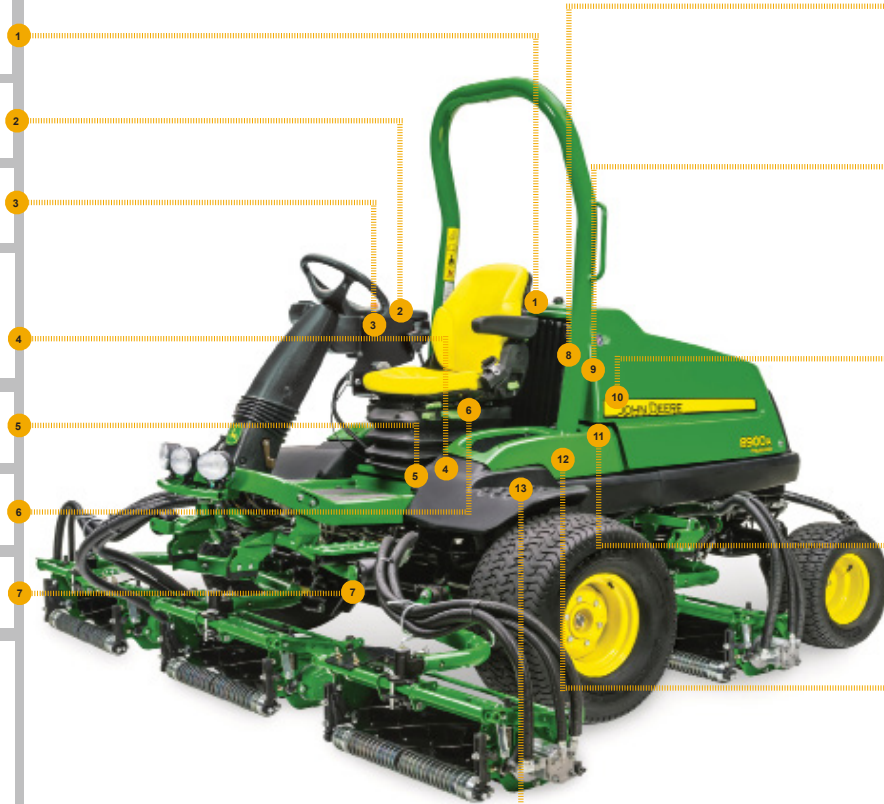

ENGINE



AIR FILTER
[RE68049](#) (SECONDARY)
[RE68048](#) (PRIMARY)
Change Every 500 Hrs.

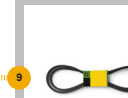

FAN BELT
[TCU38089](#) (NON TIER 4) (LGTH = 1475 mm, TK = 12mm, WIDTH = 11 mm.)
[TCU30780](#) (TIER 4) (LGTH = 1425 mm, TK = 12mm, WIDTH = 11 mm.)



OIL FILTER
[M806419](#)



ENGINE OIL
[TY26674](#) (PLUS-50™ II 15W-40) (3.4 L (3.6 qt))
Change Every 250/500 Hrs.



FUEL FILTER
[MIU800645](#) (NON TIER 4)
[MIU803127](#) (TIER 4)
Change Every 500 Hrs.



FUEL SEPARATOR
[M811032](#) (NON TIER 4)
[MIA885326](#) (TIER 4)



HYDRAULIC FILTER
[MIU802216](#)
Change Every 50 Hrs.

REPLACEMENT PARTS GUIDE

8900A Cutting Unit Roller

SCRAPER

- [BUC10076](#) (FRONT SCRAPPER) (26 INCH)
- [BUC10110](#) (REAR SCRAPPER) (26 INCH)
- [BUC10077](#) (FRONT SCRAPPER) (30 INCH)
- [BUC10111](#) (REAR SCRAPPER) (30 INCH)
- [BM23005](#) (GROOVED ROLLER SCRAPPER) (26 INCH)
- [BM23004](#) (GROOVED ROLLER SCRAPPER) (30 INCH)
- [MT2340](#) (GROOVED SCRAPPER) (CENTER)
- [MT2341](#) (GROOVED SCRAPPER) (4 SECTION)
- [MT2342](#) (GROOVED SCRAPPER) (3 SECTION)
- [TCU27070](#) (ROLLER SCRAPPER) (30 INCH)
- [TCU27069](#) (ROLLER SCRAPPER) (26 INCH)
- [BUC10326](#) (MOWER REEL, SCRAPPER KIT) (30 INCH)
- [BUC10325](#) (MOWER REEL, SCRAPPER KIT) (26 INCH)

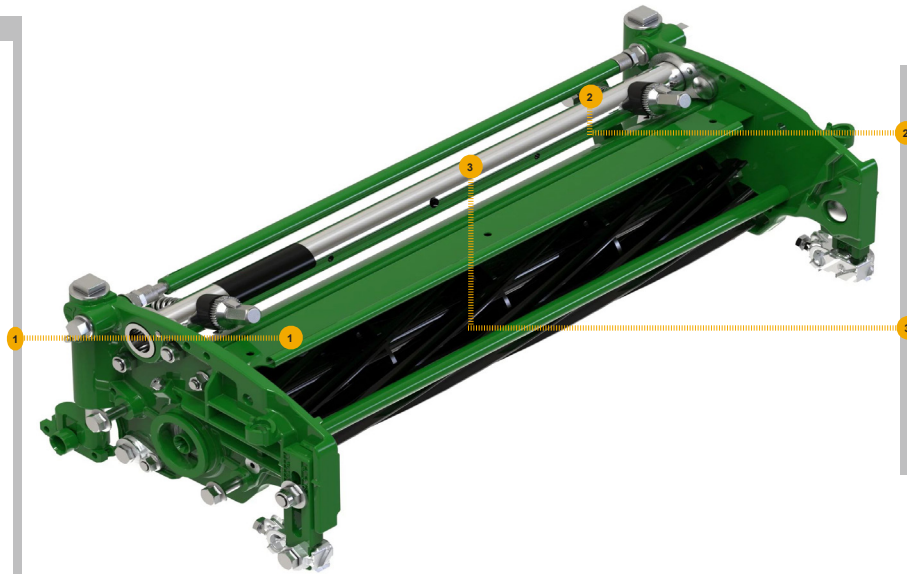

TORSION SPRING

- [TCU27036](#) (RH)
- [TCU27037](#) (LH)

ROLLER

- [BM18439](#) (SMOOTH ROLLER) (30 INCH)
- [BM25318](#) (GROOVED ROLLERS) (26 INCH)
- [BM25319](#) (GROOVED ROLLERS) (30 INCH)
- [BM19818](#) (MACHINED SPIRAL) (26 INCH)
- [BM19819](#) (MACHINED SPIRAL) (30 INCH)
- [AUC10877](#) (ROLLER) (26 INCH)

REPLACEMENT PARTS GUIDE

8900A Reel and Vertical Cutting Unit

REEL

- [TCA19357](#) (5 BLADE)
- [TCA19358](#) (8 BLADE)
- [AUC16878](#) (10 BALDE)

SHAFT

- [AUC10148](#) (30 INCH)

ADJUSTER

- [TCU25315](#) (26 INCH)
- [TCU25317](#) (26 INCH)
- [TCU26123](#) (30 INCH)
- [AUC13597](#) (30 INCH)

BRACKET

- [UC18211](#) (RH, IF USING FTC / GTC)
(LH, IF NO FTC / GTC)
- [UC16109](#) (LH, IF USING FTC / GTC)
(RH, IF NO FTC / GTC)

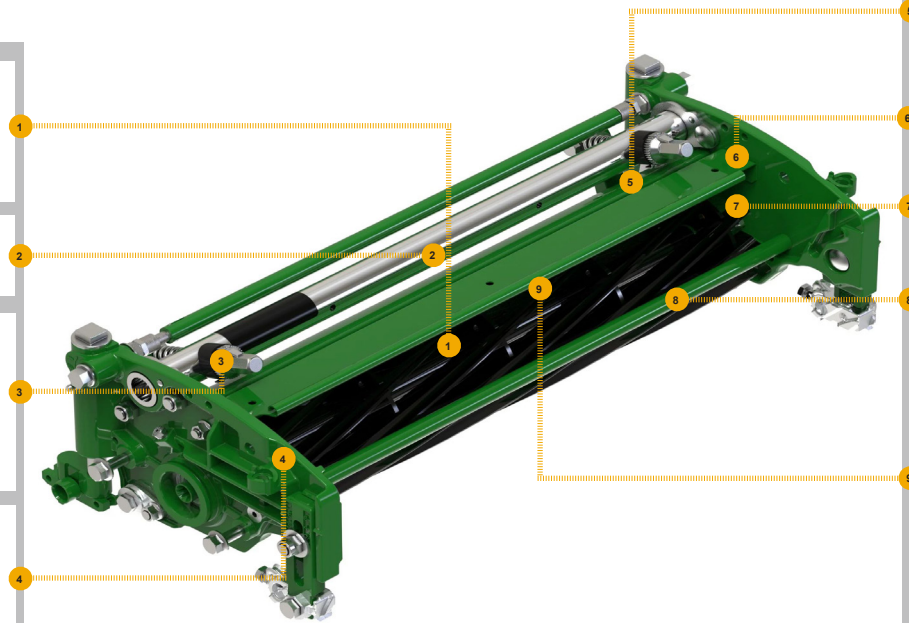

VERTICAL CUTTER

- [BUC10409](#) (26 INCH)
- [BUC10410](#) (30 INCH)

DISK

- [MT6987](#)

SYNCHRONOUS BELT

- [TCU32423](#) (LGTH = 474 mm, WIDTH = 11 mm)

GRASS CATCHER

- [BUC10569](#) (26 INCH)

BED KNIFE

- [UC23481](#) (STANDARD) (26 INCH)
(HEIGHT OF CUT = 15.8 mm)
- [UC23566](#) (STANDARD) (26 INCH)
(HEIGHT OF CUT = 6.3 mm)
- [TCU34070](#) (FAIRWAY) (26 INCH)
(HEIGHT OF CUT = 6.3 mm)
- [UC23564](#) (STANDARD) (30 INCH)
(HEIGHT OF CUT = 15.8 mm)